

Thyristor Module

$$V_{RRM} = 1600 \text{ V}$$

$$I_{TAV} = 560 \text{ A}$$

$$V_T = 1.01 \text{ V}$$

Single Thyristor

Part number

MCO500-16io1

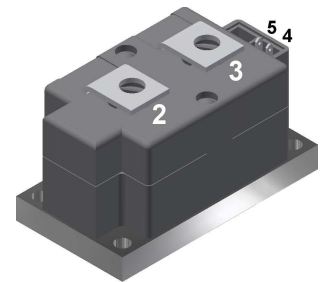

Backside: isolated

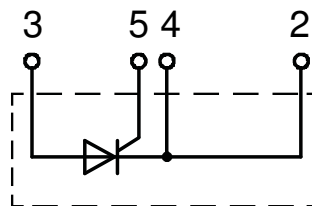

Features / Advantages:

- Thyristor for line frequency
- Planar passivated chip
- Long-term stability
- Direct Copper Bonded Al₂O₃-ceramic

Applications:

- Line rectifying 50/60 Hz
- Softstart AC motor control
- DC Motor control
- Power converter
- AC power control
- Lighting and temperature control

Package: Y1

- Isolation Voltage: 3600 V~
- Industry standard outline
- RoHS compliant
- Soldering pins for PCB mounting
- Base plate: Copper internally DCB isolated
- Advanced power cycling

Terms and Conditions of Usage

The data contained in this product data sheet is exclusively intended for technically trained staff. The user will have to evaluate the suitability of the product for the intended application and the completeness of the product data with respect to his application. The specifications of our components may not be considered as an assurance of component characteristics. The information in the valid application- and assembly notes must be considered. Should you require product information in excess of the data given in this product data sheet or which concerns the specific application of your product, please contact your local sales office.

Due to technical requirements our product may contain dangerous substances. For information on the types in question please contact your local sales office.

Should you intend to use the product in aviation, in health or life endangering or life support applications, please notify. For any such application we urgently recommend

- to perform joint risk and quality assessments;

- the conclusion of quality agreements;

- to establish joint measures of an ongoing product survey, and that we may make delivery dependent on the realization of any such measures.

Thyristor				Ratings			
Symbol	Definition	Conditions	min.	typ.	max.	Unit	
$V_{RSM/DSM}$	max. non-repetitive reverse/forward blocking voltage				1700	V	
$V_{RRM/DRM}$	max. repetitive reverse/forward blocking voltage				1600	V	
I_{RD}	reverse current, drain current	$V_{R/D} = 1600$ V			2	mA	
		$V_{R/D} = 1600$ V			40	mA	
V_T	forward voltage drop	$I_T = 500$ A			1.08	V	
		$I_T = 1000$ A			1.27	V	
		$I_T = 500$ A	$T_{VJ} = 125^\circ\text{C}$			1.01	V
		$I_T = 1000$ A	$T_{VJ} = 125^\circ\text{C}$			1.24	V
I_{TAV}	average forward current	$T_C = 85^\circ\text{C}$			560	A	
$I_{T(RMS)}$	RMS forward current	180° sine			880	A	
V_{T0}	threshold voltage	} for power loss calculation only			0.80	V	
r_T	slope resistance				0.38	mΩ	
R_{thJC}	thermal resistance junction to case				0.072	K/W	
R_{thCH}	thermal resistance case to heatsink			0.024		K/W	
P_{tot}	total power dissipation		$T_C = 25^\circ\text{C}$		1600	W	
I_{TSM}	max. forward surge current	t = 10 ms; (50 Hz), sine	$T_{VJ} = 45^\circ\text{C}$		17.0	kA	
		t = 8,3 ms; (60 Hz), sine	$V_R = 0$ V		18.4	kA	
		t = 10 ms; (50 Hz), sine	$T_{VJ} = 140^\circ\text{C}$		14.5	kA	
		t = 8,3 ms; (60 Hz), sine	$V_R = 0$ V		15.6	kA	
I^2t	value for fusing	t = 10 ms; (50 Hz), sine	$T_{VJ} = 45^\circ\text{C}$		1.45	MA ² s	
		t = 8,3 ms; (60 Hz), sine	$V_R = 0$ V		1.40	MA ² s	
		t = 10 ms; (50 Hz), sine	$T_{VJ} = 140^\circ\text{C}$		1.04	MA ² s	
		t = 8,3 ms; (60 Hz), sine	$V_R = 0$ V		1.01	MA ² s	
C_J	junction capacitance	$V_R = 400$ V f = 1 MHz	$T_{VJ} = 25^\circ\text{C}$		876	pF	
P_{GM}	max. gate power dissipation	$t_p = 30$ μs	$T_C = 140^\circ\text{C}$		120	W	
		$t_p = 300$ μs			60	W	
P_{GAV}	average gate power dissipation				20	W	
$(di/dt)_{cr}$	critical rate of rise of current	$T_{VJ} = 140^\circ\text{C}; f = 50$ Hz repetitive, $I_T = 1500$ A			100	A/μs	
		$t_p = 200$ μs; $di_G/dt = 1$ A/μs; $I_G = 1$ A; $V = \frac{2}{3} V_{DRM}$ non-repet., $I_T = 500$ A			500	A/μs	
$(dv/dt)_{cr}$	critical rate of rise of voltage	$V = \frac{2}{3} V_{DRM}$	$T_{VJ} = 140^\circ\text{C}$		1000	V/μs	
		$R_{GK} = \infty$; method 1 (linear voltage rise)					
V_{GT}	gate trigger voltage	$V_D = 6$ V	$T_{VJ} = 25^\circ\text{C}$		2	V	
			$T_{VJ} = -40^\circ\text{C}$		3	V	
I_{GT}	gate trigger current	$V_D = 6$ V	$T_{VJ} = 25^\circ\text{C}$		300	mA	
			$T_{VJ} = -40^\circ\text{C}$		400	mA	
V_{GD}	gate non-trigger voltage	$V_D = \frac{2}{3} V_{DRM}$	$T_{VJ} = 140^\circ\text{C}$		0.25	V	
I_{GD}	gate non-trigger current				10	mA	
I_L	latching current	$t_p = 30$ μs	$T_{VJ} = 25^\circ\text{C}$		400	mA	
		$I_G = 1$ A; $di_G/dt = 1$ A/μs					
I_H	holding current	$V_D = 6$ V $R_{GK} = \infty$	$T_{VJ} = 25^\circ\text{C}$		300	mA	
t_{gd}	gate controlled delay time	$V_D = \frac{1}{2} V_{DRM}$	$T_{VJ} = 25^\circ\text{C}$		2	μs	
		$I_G = 1$ A; $di_G/dt = 1$ A/μs					
t_q	turn-off time	$V_R = 100$ V; $I_T = 500$ A; $V = \frac{2}{3} V_{DRM}$ $di/dt = 10$ A/μs $dv/dt = 50$ V/μs $t_p = 200$ μs	$T_{VJ} = 125^\circ\text{C}$		350	μs	

Package Y1			Ratings			
Symbol	Definition	Conditions	min.	typ.	max.	Unit
I_{RMS}	RMS current	per terminal			600	A
T_{VJ}	virtual junction temperature		-40		140	°C
T_{op}	operation temperature		-40		125	°C
T_{stg}	storage temperature		-40		125	°C
Weight				650		g
M_D	mounting torque		4.5		7	Nm
M_T	terminal torque		11		13	Nm
$d_{Spp/App}$	creepage distance on surface striking distance through air	terminal to terminal	16.0			mm
$d_{Spb/Apb}$		terminal to backside	25.0			mm
V_{ISOL}	isolation voltage	t = 1 second	3600			V
		t = 1 minute	3000			V

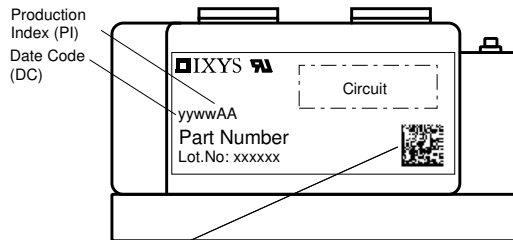

Data Matrix: part no. (1-19), DC + PI (20-25), lot.no.# (26-31), blank (32), serial no.# (33-36)

Ordering	Ordering Number	Marking on Product	Delivery Mode	Quantity	Code No.
Standard	MCO500-16io1	MCO500-16io1	Box	3	463744

Similar Part	Package	Voltage class
MCO500-12io1	Y1-2-CU	1200
MCO500-14io1	Y1-2-CU	1400
MCO500-18io1	Y1-2-CU	1800
MCO600-20io1	Y1-2-CU	2000
MCO600-22io1	Y1-2-CU	2200

Equivalent Circuits for Simulation * on die level $T_{VJ} = 140\text{ }^{\circ}\text{C}$

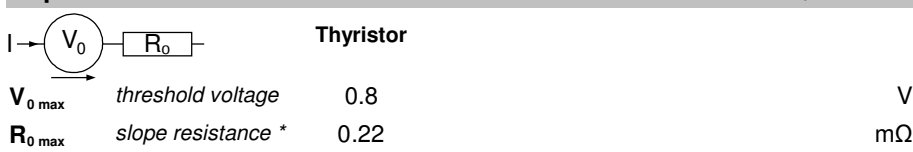

Outlines Y1

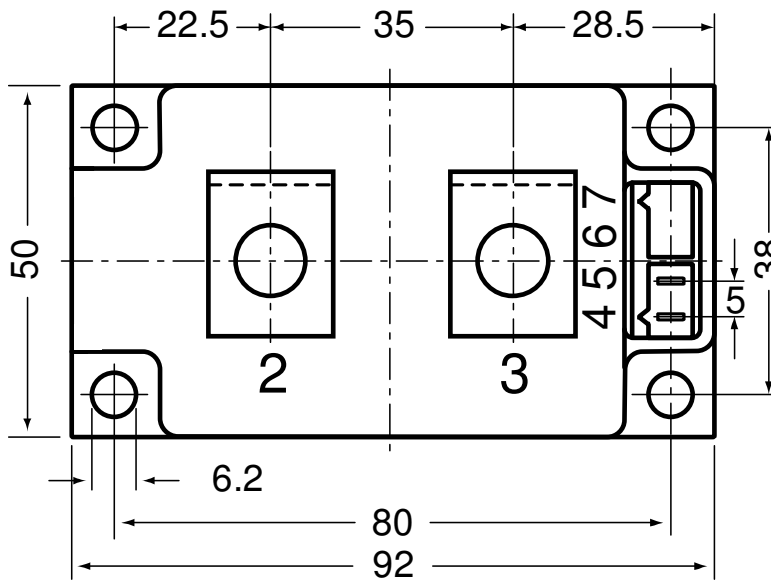
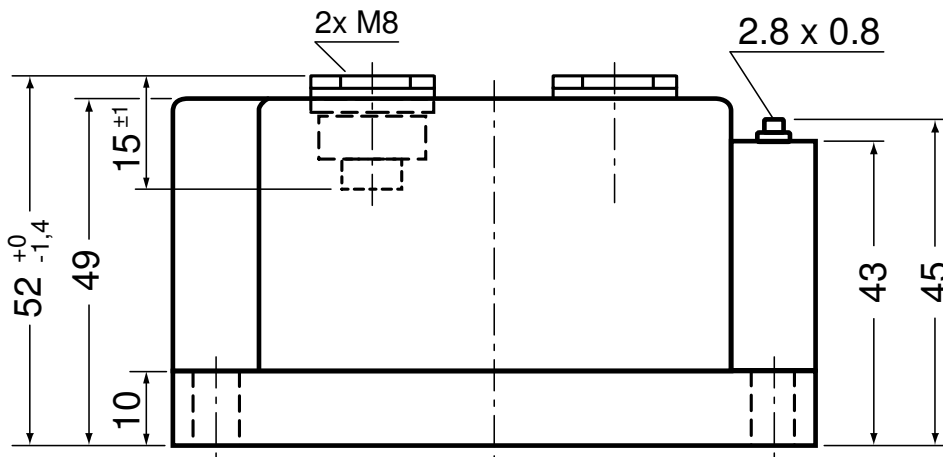

Optional accessories for modules

Keyed gate/cathode twin plugs with wire length = 350 mm, gate = white, cathode = red

Type ZY 180L (L = Left for pin pair 4/5) } UL 758, style 3751
 Type ZY 180R (R = Right for pin pair 6/7) }

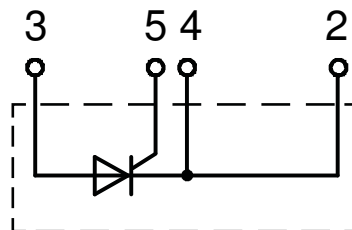

Thyristor

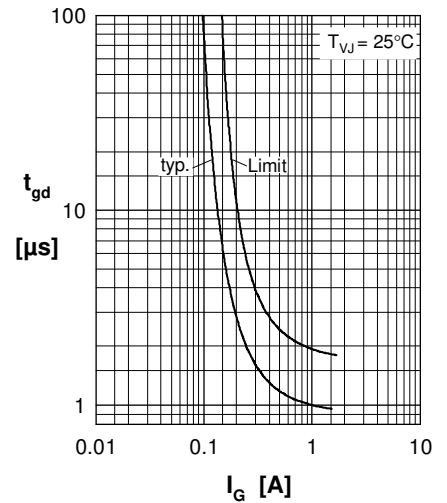
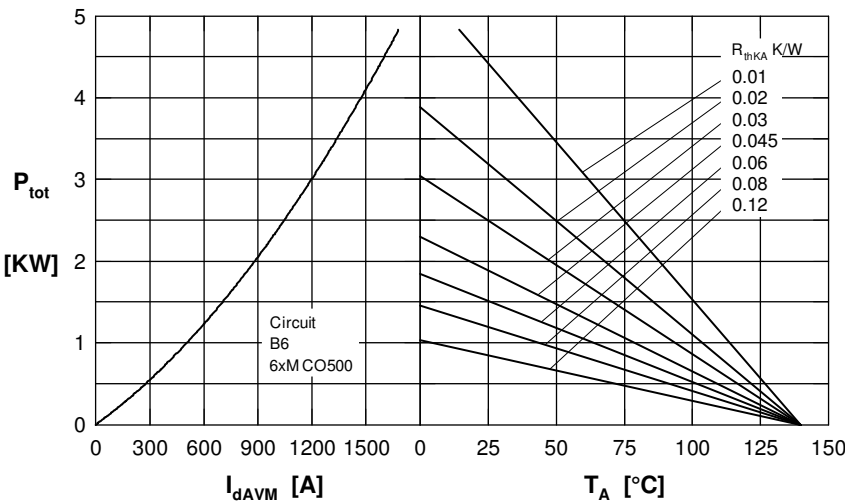
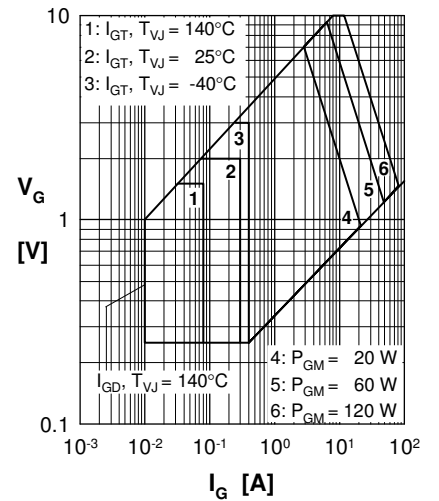
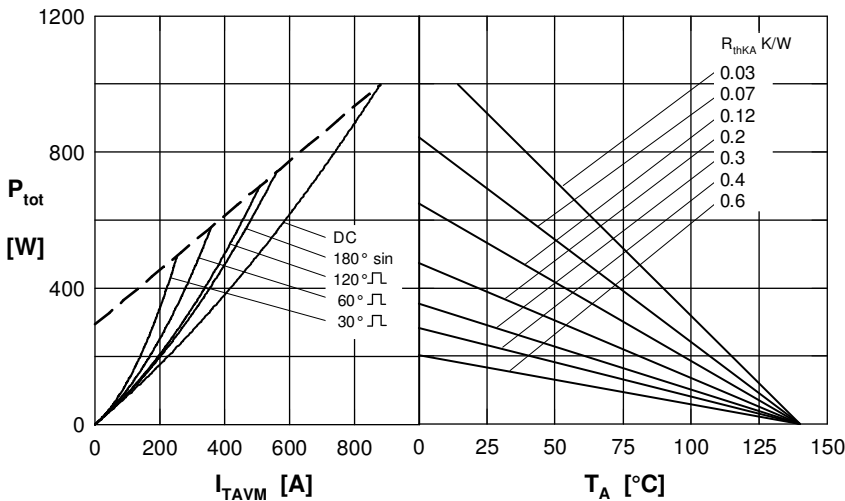
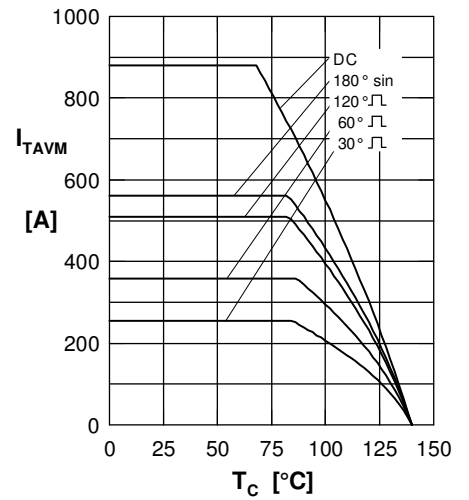
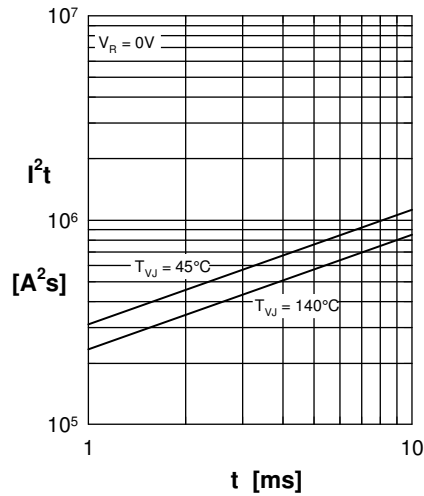
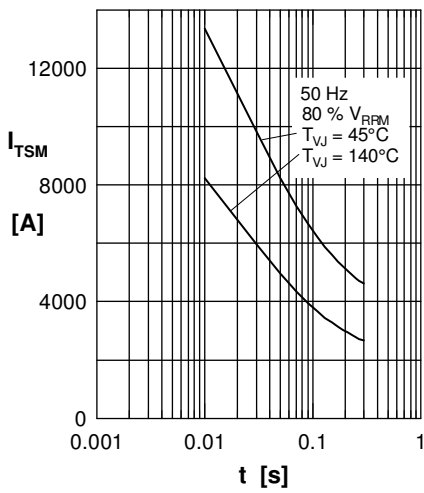

Thyristor

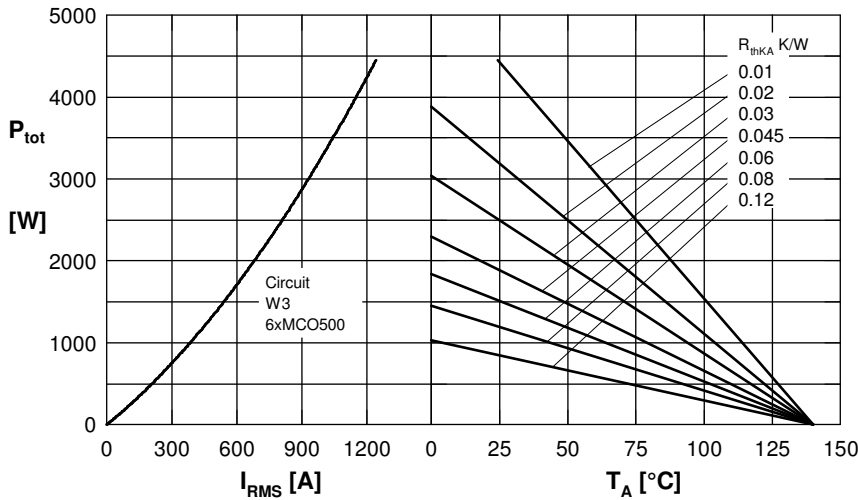

Fig. 8 Three phase AC-controller: Power dissipation versus RMS output current and ambient temperature

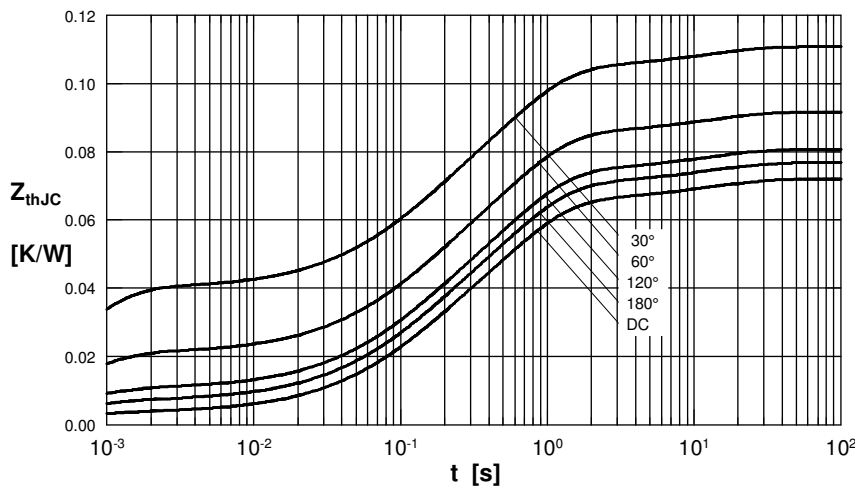

Fig. 9 Transient thermal impedance junction to case

R_{thJC} for various conduction angles d:

d	R_{thJC} (K/W)
DC	0.072
180°	0.0768
120°	0.081
60°	0.092
30°	0.111

Constants for Z_{thJC} calculation:

i	R_{thi} (K/W)	t_i (s)
1	0.0035	0.0054
2	0.0186	0.098
3	0.0432	0.54
4	0.0067	12

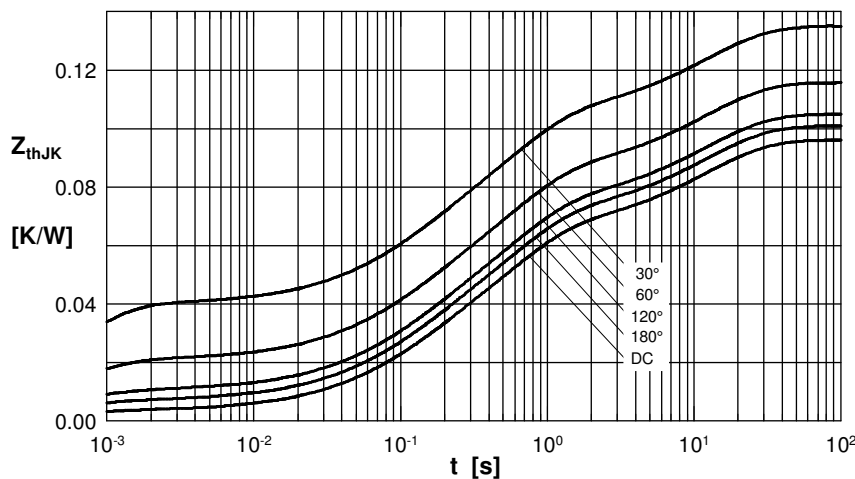

Fig.10 Transient thermal impedance junction to heatsink

R_{thJK} for various conduction angles d:

d	R_{thJK} (K/W)
DC	0.096
180°	0.1
120°	0.105
60°	0.116
30°	0.135

Constants for Z_{thJK} calculation:

i	R_{thi} (K/W)	t_i (s)
1	0.0035	0.0054
2	0.0186	0.098
3	0.0432	0.54
4	0.0067	12
5	0.024	12